



Up-to-date Practice Test with Latest Questions and Answers covering latest syllabus and topics of the exam. Makes you ready to face actual exam.



312-96 Practice Questions
312-96 Practice Test
312-96 Practice Exam
312-96 Exam Questions
312-96 Study Guide



killexams.com

EC-Council

312-96

*Certified Application Security Engineer (C|ASE Java)
Certification*

ORDER FULL VERSION

<https://killexams.com/pass4sure/exam-detail/312-96>



Question: 56

Which of the following is a secure coding practice to prevent Remote Code Execution vulnerabilities?

- A. Allowing user-supplied input to be executed without proper validation
- B. Disabling input validation for code execution
- C. Implementing input validation and sanitization for code execution
- D. Using weak or common passwords

Answer: C

Explanation: Implementing input validation and sanitization for code execution is a secure coding practice to prevent Remote Code Execution vulnerabilities. By validating and sanitizing user-supplied input before executing it as code, the risk of malicious code execution can be mitigated. Allowing user-supplied input to be executed without proper validation, disabling input validation for code execution, and using weak or common passwords are insecure practices that can contribute to Remote Code Execution vulnerabilities.

Question: 57

Which of the following is a secure coding practice to prevent Security Vulnerabilities in third-party libraries?

- A. Using outdated and unpatched libraries
- B. Disabling input validation for libraries
- C. Storing sensitive data in plain text in the libraries
- D. Implementing regular updates and patching for libraries

Answer: D

Explanation: Implementing regular updates and patching for libraries is a secure coding practice to prevent Security Vulnerabilities in third-party libraries. By keeping libraries up to date and applying patches promptly, the application can address known vulnerabilities and reduce the risk of exploitation. Using outdated and unpatched libraries, disabling input validation for libraries, and storing sensitive data in plain text in the libraries are insecure practices that can contribute to security vulnerabilities.

Question: 58

Sam, an application security engineer working in INFRA INC., was conducting a secure code review on an application developed in Java. He found that the developer has used a piece of code as shown in the following screenshot.

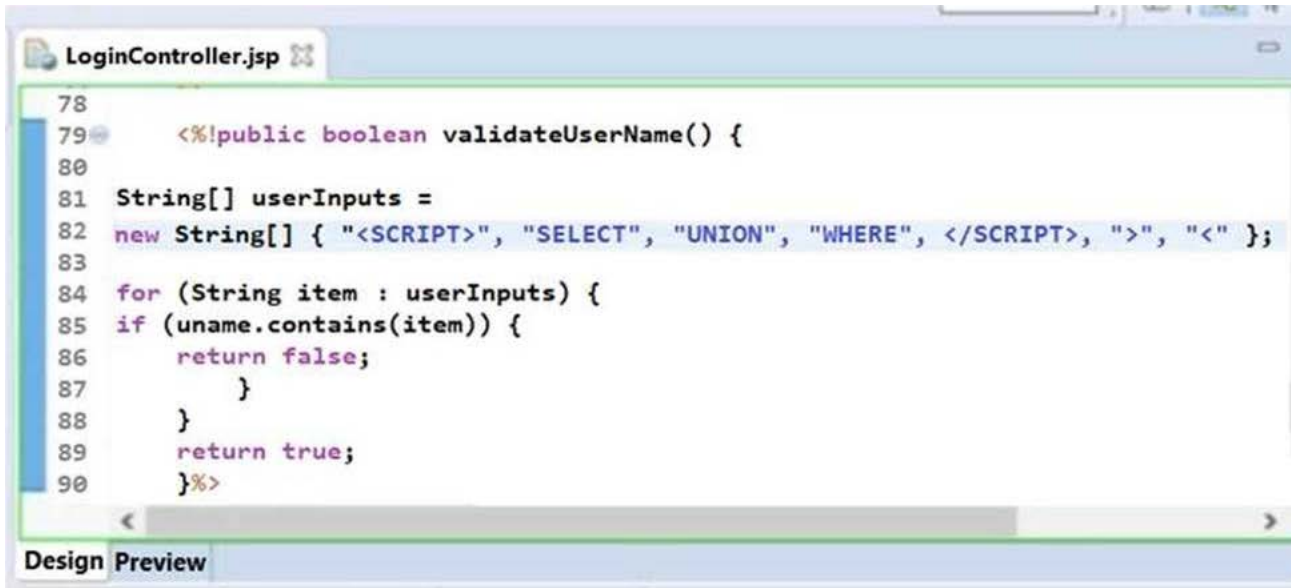

```
78
79 <%!public boolean validateUserName() {
80
81 String[] userInputs =
82 new String[] { "<SCRIPT>", "SELECT", "UNION", "WHERE", </SCRIPT>", ">", "<" };
83
84 for (String item : userInputs) {
85 if (uname.contains(item)) {
86 return false;
87 }
88 }
89 return true;
90 }%>
```

Identify the security mistakes that the developer has coded?

- A. He is attempting to use client-side validation
- B. He is attempting to use whitelist input validation approach
- C. He is attempting to use regular expression for validation
- D. He is attempting to use blacklist input validation approach

Answer: D

Question: 59

Identify the type of attack depicted in the following figure.

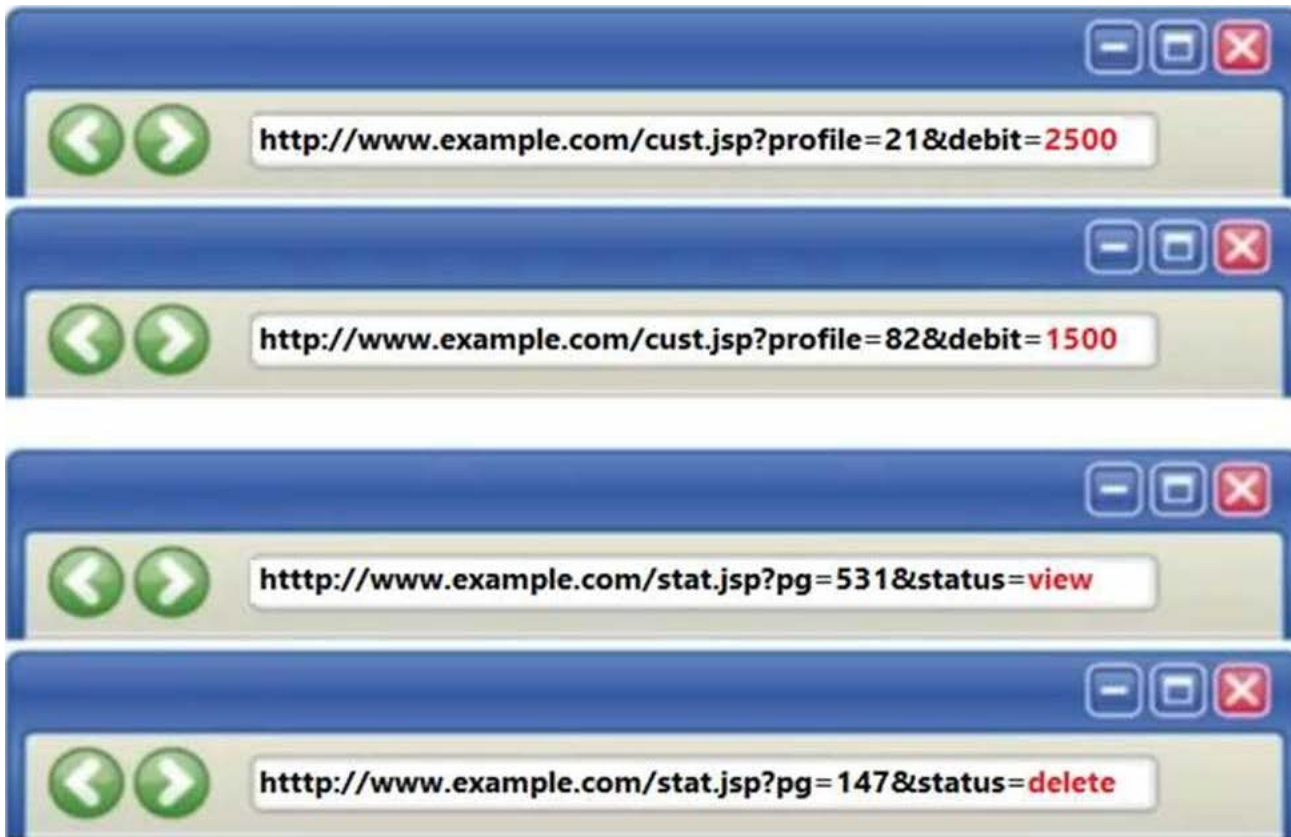

- A. SQL Injection Attacks
- B. Session Fixation Attack
- C. Parameter Tampering Attack
- D. Denial-of-Service Attack

Answer: C

Question: 60

According to secure logging practices, programmers should ensure that logging processes are not disrupted by:

- A. Catching incorrect exceptions
- B. Multiple catching of incorrect exceptions
- C. Re-throwing incorrect exceptions
- D. Throwing incorrect exceptions

Answer: D

Question: 61

Which of the threat classification model is used to classify threats during threat modeling process?

- A. RED
- B. STRIDE
- C. DREAD
- D. SMART

Answer: B

Question: 62

Which line of the following example of Java Code can make application vulnerable to a session attack?

```
1:  Public class storecookie extends HttpServlet {
2:  Public void doGet () {
3:  Cookie ssnCookie = new Cookie ("Session Cookie" + value);
4:  ssnCookie.setMaxAge (3600);
5:  response.addCookie (ssnCookie);
6:  }
```

- A. Line No. 1
- B. Line No. 3
- C. Line No. 4
- D. Line No. 5

Answer: B

Question: 63

Alice, a Server Administrator (Tomcat), wants to ensure that Tomcat can be shut down only by the user who owns the Tomcat process. Select the appropriate setting of the CATALINA_HOME/conf in server.xml that will enable him to do so.

- A. < server port="" shutdown="" >
- B. < server port="-1" shutdown="*" >
- C. < server port="-1" shutdown="SHUTDOWN" >
- D. < server port="8080" shutdown="SHUTDOWN" >

Answer: B

Question: 64

Which of the following method will help you check if DEBUG level is enabled?

- A. isDebugEnabled()
- B. EnableDebug ()
- C. IsEnableDebug ()
- D. DebugEnabled()

Answer: A

Question: 65

Which of the following elements in web.xml file ensures that cookies will be transmitted over an encrypted channel?

- A. < connector IsSSLEnabled="Yes" / >
- B. < connector EnableSSL="true" / >
- C. < connector SSLEnabled="false" / >
- D. < connector SSLEnabled="true" / >

Answer: D

Question: 66

In which phase of secure development lifecycle the threat modeling is performed?

- A. Coding phase
- B. Testing phase
- C. Deployment phase
- D. Design phase

Answer: D

Question: 67

Identify the type of attack depicted in the figure below:

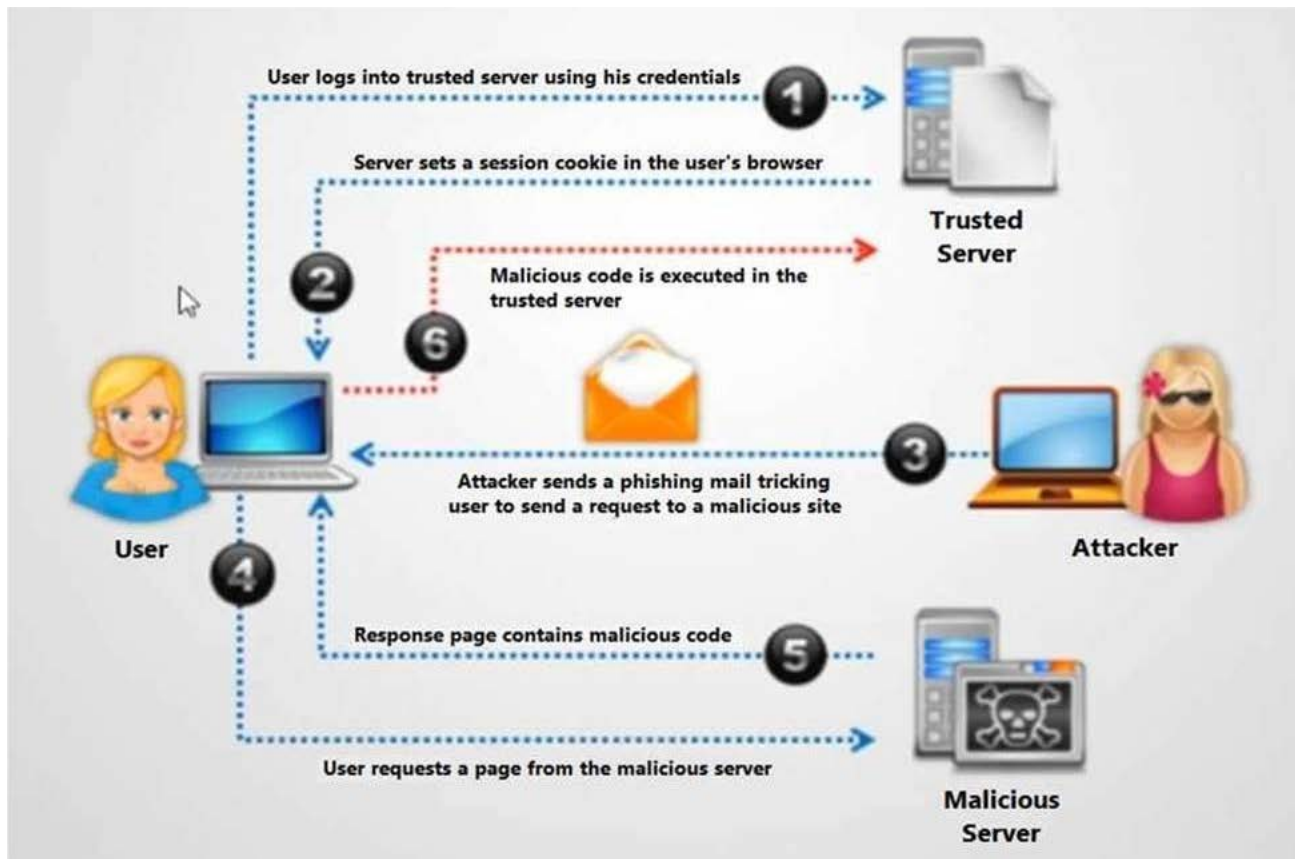

- A. XSS
- B. Cross-Site Request Forgery (CSRF) attack

- C. SQL injection attack
- D. Denial-of-Service attack

Answer: B

Killexams.com is a leading online platform specializing in high-quality certification exam preparation. Offering a robust suite of tools, including Exam Questions, practice tests, and advanced test engines, Killexams.com empowers candidates to excel in their certification exams. Discover the key features that make Killexams.com the go-to choice for exam success.



Practice Exam Questions Based on Current Exam Objectives

Killexams.com provides practice exam questions aligned with the latest official exam objectives and latest syllabus. Our content is reviewed and updated regularly to reflect recent changes announced by certification vendors. By studying these practice questions, candidates will cover the structure, difficulty level, and topics of the actual exam, helping them prepare more effectively and efficiently.

Comprehensive Practice Exams (PDF Format)

Killexams.com offers multiple-choice questions (MCQs) in easy-to-read PDF format, covering all major domains of the exam. Each PDF contains a structured collection of practice questions and verified answers designed to support focused study. These MCQs help candidates reinforce key concepts, identify knowledge gaps, and improve exam readiness through consistent practice.

Realistic Practice Tests (Online Test Engine & Desktop Test Engine)

To support hands-on preparation, Killexams.com provides practice tests through both an Online Test Engine and a Desktop Test Engine. These tools are designed to simulate a real exam environment, allowing candidates to practice under exam-like conditions, with latest syllabus and topics of the exam. Performance tracking, test history, and result analysis help users evaluate their progress and focus on areas that need improvement.

Risk-Free Purchase Policy

Killexams.com follows a transparent and customer-friendly purchase policy. If users are not satisfied with the study materials, they may request assistance or a refund in accordance with our published terms and conditions. This policy reflects our commitment to customer satisfaction, fairness, and confidence in our preparation resources.

Regularly Updated Content

Our practice question bank is reviewed and updated on an ongoing basis to stay aligned with the latest exam outlines and vendor updates. This ensures candidates are studying up-to-date, relevant material, and preparing with content that reflects current exam expectations, helping them stay confident and well-prepared.